



Product Data Sheet

TVD-1104

3 MPX Full HD Outdoor IR Dome Camera, 2.8 to 12mm, PAL

Overview

The TVD-1104 is a Full HD IP Outdoor IR Dome camera designed to perform in a wide range of lighting conditions. Its built-in IR LEDs provide illumination up to 15 meters to ensure images – even in low light environments. The camera's Digital Wide Dynamic Range feature ensures that images are obtained, even in backlight scenes. The camera is compliant with the ONVIF and PSIA open standards.

Additional Features

Featuring an integrated browser and available micro SD card storage capabilities, TruVision IP cameras simplify remote live monitoring/playback of edge-recorded video and audio. Recording on the memory card also provides a level of redundancy in case of unforeseen network disruptions.

IP technology

TruVision cameras utilize H.264 compression with dual-streaming capability, making it easy to manage the camera's bandwidth usage. These cameras have been designed to adhere to PSIA and ONVIF open communication standards, and also support a CGI command set for simple integration into any IP system. Video streams can be set up for high and low bandwidth and images can be streamed for live viewing or sent to a designated recording location.



Standard Features

- IR Dome camera
- Real time Full HD 1080p resolution
- Maximum resolution QXGA (2048 x 1536)
- H.264 with dual streaming functionality
- 1/3" CMOS Progressive Scan
- Motorized IR cut filter
- Digital Wide Dynamic Range
- 0 Lux (IR on)
- Up to 15m IR illumination
- 2.8 to 12mm lens
- Edge recording up to 64GB
- Designed to ONVIF and PSIA open standards

TVD-1104

3 MPX Full HD Outdoor IR Dome Camera, 2.8 to 12mm, PAL

Specifications

Camera		
Sensor Size:	1/3"	
SD / MPX:	3MPX	
Sensor scan:	Progressive Scan	
Sensor type:	CMOS	
IP Compression / Standard:	Main stream: H.264 H.264/MJPEG	Sub stream:
Available Resolutions:	Main stream: 2048x1536,1920x1080,1280x720 Sub stream: 704x576,352x288,320x240	
Maximum Resolution (@ FPS):	2048 x 1536 @12.5 fps	
Maximum Real Time Resolution:	1920x1080	
HD 720p:	Yes	
Full HD 1080p:	Yes	
Digital S/N ratio:	50dB	
Electronic shutter:	1/25s to 1/100.000s	
Certification:	UL, CE, FCC, C-tick, REACH, RoHS, HALT, WEEE	

Lighting performance		
Wide Dynamic Range:	DWDR	
WDR in dB:	72dB	
Digital noise reduction:	3D DNR	
Day/Night:	True Day/Night	
Motorized IR Cut Filter:	Yes	
Color sensitivity:	0.01 lux @ F1.2	
B/W sensitivity:	0 Lux with IR	
IR sensitivity:	0 Lux with IR	
IR Range:	Up to 15m	
IR Wavelength:	850nm	
B/W trigger:	3.09Lux	
IR trigger:	3.09Lux	

Housing		
Camera type:	Dome	
IP rating:	IP66	
Outdoor:	Outdoor	
Rugged:	IK10 Rating	

Lens		
Control type:	Vari focal	
Optical zoom:	No	
Focal length:	2.8 to 12 mm	
F-stop:	1,4	
Autoiris:	Yes	
Zoom lens:	No	
Autofocus:	No	

Power consumption		
Voltage Input:	12VDC± 10%	
Current:	Max. 0.46A	
Power Consumption:	Max. 5.5W	
PoE:	PoE(802.3af)	

Network		
ONVIF:	2.2	
PSIA:	1.1	
CGI:	Yes	
Network Protocols:	TCP/IP, HTTP, DHCP, DNS, DDNS, RTP, RTSP, PPPoE, SMTP, NTP, UPnP, SNMP, HTTPS, FTP, 802.1x, Qos, IPv4/IPv6	

Local Storage		
Media:	Built-in Micro SD/SDHC/SDXC card slot	
Capacity:	64GB	

Audio G.711/G.726		
Input:	Wire for 1ch. audio interface (2.0 - 2.4 Vp-p, 1 kOhm)	
Output	Wire for 1ch. audio interface (Line level, 600 Ohm)	

Camera Analytics		
Motion Detection:	Yes	
Privacy Masking:	4	

Alarm		
Alarm Input:	1	
Alarm Output:	1	

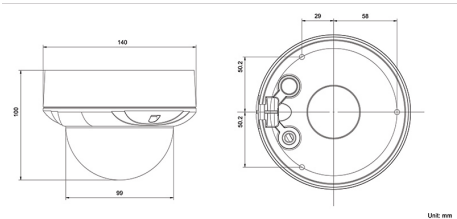

As a company of innovation, UTC Fire & Security reserves the right to change product specifications without notice. For the latest product specifications, visit [UTC Fire & Security online](#) or contact your sales representative.

Dimensions:	Ø 140 x 100 mm (Ø 5,5 x 3,9 in)
Weight:	767g (1.7lb)
Cold start Temperature	-20°C (-4°F)
Operating Temperature:	-30°C to 60°C



UTC Fire & Security

A United Technologies Company